

SHAFTALIGN® touch

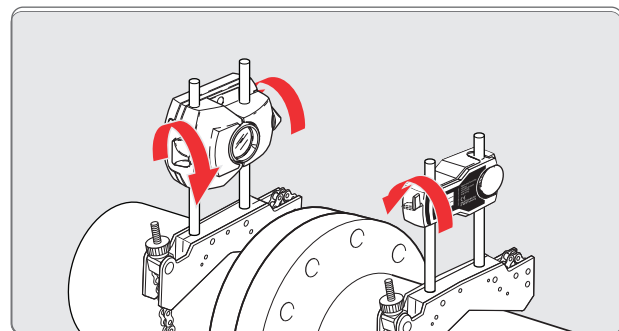
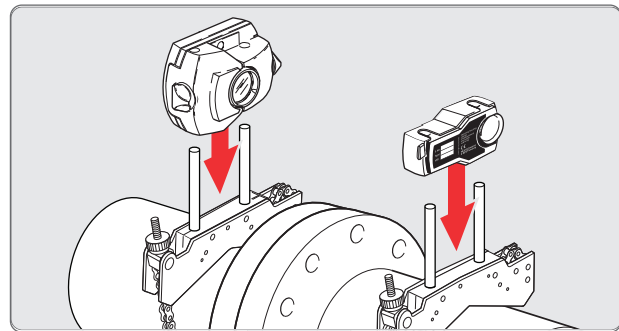
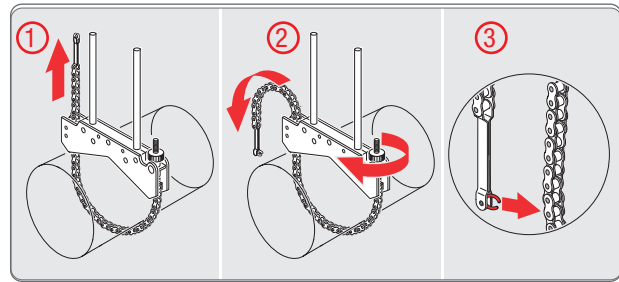

Contents subject to change without further notice, particularly in the interest of further technical development. © Copyright 2020 by PRÜFTECHNIK Condition Monitoring GmbH

1

2



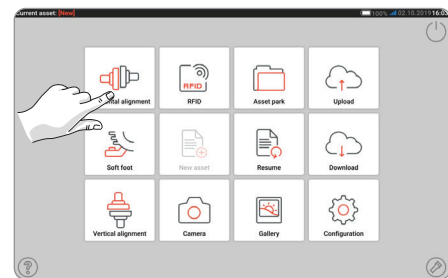

3

4

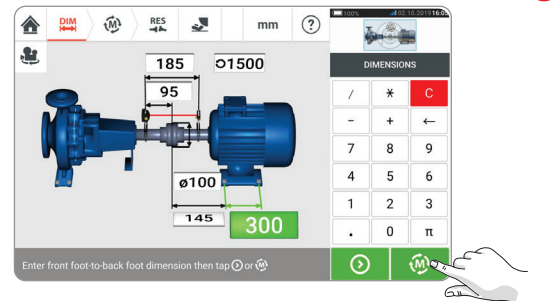
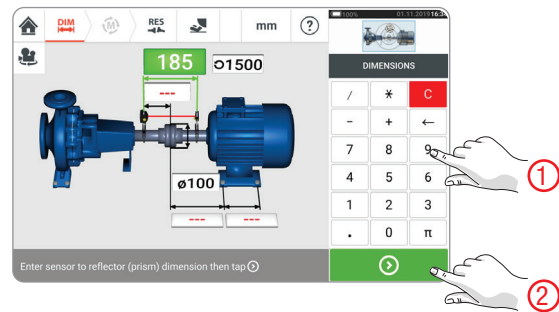
5

6

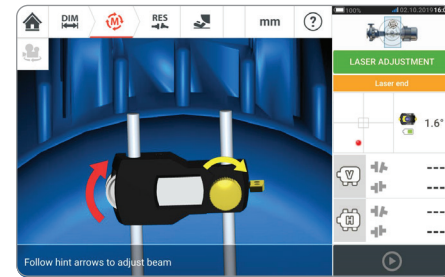
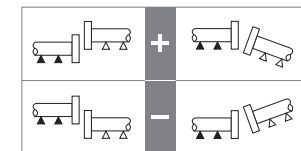
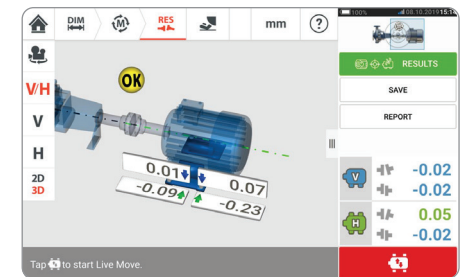
	/100 mm		/10"	
⊗	OK (mm)	⚠ (mm)	OK (mil)	⚠ (mil)
600	0.15	0.10	14.9	10.0
750	0.12	0.08	12.3	8.2
900	0.10	0.07	10.5	7.0
1000	0.10	0.06	9.6	6.4
1200	0.08	0.05	8.2	5.4
1500	0.07	0.04	6.7	4.5
1800	0.06	0.04	5.7	3.8
3000	0.04	0.02	3.7	2.5
3600	0.03	0.02	3.1	2.1
6000	0.02	0.01	2.0	1.3
7200	0.02	0.01	1.7	1.1

	/100 mm		/10"	
⊗	OK (mm)	⚠ (mm)	OK (mil)	⚠ (mil)
600	0.23	0.13	9.0	5.1
750	0.18	0.10	7.3	4.1
900	0.16	0.09	6.1	3.4
1000	0.14	0.08	5.5	3.1
1200	0.12	0.07	4.6	2.6
1500	0.09	0.05	3.7	2.1
1800	0.08	0.04	3.1	1.8
3000	0.05	0.03	1.9	1.1
3600	0.04	0.02	1.6	0.9
6000	0.02	0.01	1.0	0.6
7200	0.02	0.01	0.8	0.5